

Archaeological Evaluation of Phase Three,
land to the rear of Hyton Drive and Roman
Close, Church Lane, Sholden,
Deal, Kent.



NGR: 636300 152650

Site Code: CLD/EV/18

Planning Application: LW/17/0226

SWAT Archaeology

The Office, School Farm Oast

Graveney Road Faversham, Kent, ME13 8UP

Email: info@swatarchaeology.co.uk

Tel.: 01795 532548 and 07885 700112

Contents

List of Figures.....	3
List of Plates.....	3
1. Summary.....	4
2. Introduction.....	4
3. Site Description and Topography.....	4
4. Planning Background.....	5
5. Archaeological and Historical Background.....	5
6. Aims and Objectives.....	5
7. Methodology.....	6
8. Monitoring.....	6
9. Results.....	7
10. Discussion.....	18
11. Finds.....	19
12. Conclusion.....	19
13. Acknowledgements.....	19
14. References.....	20

List of Figures:

Figure 1 – Location of site

Figure 2 – Plan of Evaluation Trenches. Scale 1:1000

Figure 2A – Plan of Evaluation Trenches. Scale 1:500

Figure 3 – Plan of Trench 2

Figure 4 – Plan of Trench 8

Figure 5 – Plan of Trench 9

Figure 6 – Plan of Trench 19

Figure 7 – Plan of Trench 20

Figure 8 – Plan of Trench 23

Figure 9 – Plan of Trench 27

Figure 10 – Plan of Trench 28

List of Plates:

Plate 1 – Trench 3, looking NE

Plate 2 – Trench 12, looking NE

Plate 3 – Unfinished, Mesolithic-Neolithic Mace/Hammer. Trench 18 (1803)

Plate 4 – Trench 19, looking NW

Plate 5 – Trench 20, looking SW

Plate 6 – Trench 23, looking NE

Plate 7 – Trench 25, looking NE

Plate 8 – Trench 26, looking NE

Plate 9 – Trench 27, looking NW

Archaeological Evaluation of Phase Three, land to the rear of Hyton Drive and Roman Close, Church Lane, Sholden, Deal, Kent.

NGR: 636300 152650

Site Code: CLD-EV-18

1. Summary

Swale & Thames Survey Company (SWAT) carried out an archaeological evaluation of land at Deal, Kent (Phase 3). A Planning Application (DOV/16/01476) to develop this site for the development of residential and affordable housing went to Dover District Council, whereby the Kent County Council advised that an Archaeological Evaluation be undertaken in order to determine the possible impact of the development on any archaeological remains. The work was carried out in accordance with the requirements set out within an Archaeological Specification (SWAT Specification 2017) and in discussion with the County Archaeologist, Kent County Council. The results of the excavation of 29 evaluation trenches revealed that archaeological features were present within 66.6% of the trenches (Figure 2). The geology revealed was superficial deposits of Head, Head Brickearth above Upper Chalk. The Archaeological Investigations have therefore been successful in fulfilling the primary aims and objectives of the Archaeological Specification.

2. Introduction

Swale & Thames Survey Company (SWAT) was commissioned by Persimmon Homes Southeast to carry out an archaeological evaluation at the above site. The work was carried out in accordance with the requirements set out within an Archaeological Specification (SWAT 2017) and in discussion with the County Archaeologist, Kent County Council. The evaluation was carried out on 29th January-2nd February 2018.

3. Site Description and Topography

The site is located on the northern edge of the modern-day town of Deal, Kent, occupying a pocket of agricultural land between Deal and the neighbouring village of Sholden (centred on NGR636300 152650). The proposed development site for Persimmon's Phase 3 is bounded to the north and west by open-fields and to the east and south by residential housing (Figure 1). The site also lies between 50m-100m north and northeast from Persimmon's Phase 1 development, which was subject to an archaeological Strip, Map and Sample (SMS) in 2013 (SWAT Archaeology 2014).

4. Planning Background

Development proposals for Phase 3 have been submitted to Dover District Council (App. DOV/16/01476) for the development of 70 residential dwellings, vehicular, pedestrian and cycle access, internal site roads and parking.

The County Archaeologist for Kent County Council recommended that the site should be subject to a programme of archaeological work in order to determine whether the extensive archaeological landscape investigated between 2013 and 2016 continued within the area for Phase 3. The results of this investigation can then guide appropriate mitigation measures for the future development.

5. Archaeological and Historical Background

The archaeological background is based on information presently recorded in the Kent HER and data from an Archaeological Desk-based Assessment (Entec 2010), an Archaeological Evaluation (Headland 2013) and the Archaeological SMS of Phase 1 (SWAT Archaeology 2014) and Phase 2 (SWAT Archaeology, forthcoming).

The archaeological investigations revealed an extensive prehistoric rural landscape, including early Neolithic farming and a monumental landscape comprising of One Neolithic-Early Bronze Age rectangular monument, four Early Bronze Age Barrows and Two Early Bronze Age 'enclosures'. The site also has a late Iron Age and Roman rural landscape and a series of fossilised Medieval boundaries underneath the present Public Footpaths.

6. Aims and Objectives

According the SWAT Archaeology Specification, the aims and objectives for the archaeological work were to ensure that:

"The principle objective of the archaeological evaluation is to establish the presence or absence of any elements of the archaeological resource, both artefacts and ecofacts of archaeological interest across the area of the development. To ascertain the extent, depth below ground surface, depth of deposit if possible, character, date and quality of any such archaeological remains by limited sample excavation.

To determine the state of preservation and importance of the archaeological resource if present and to assess the past impacts on the site and pay particular attention to the character, height/depth below ground level, condition, date and significance of any archaeological deposits” (SWAT 2017).

7. Methodology

The Archaeological Specification called for an evaluation by trial trenching comprising 29 trenches within the footprint of the proposed development (Figure 2). A 14 ton 360 ° tracked mechanical excavator with a 1.8m wide flat-bladed ditching bucket was used to remove the topsoil and subsoil to expose the natural geology and/or the archaeological horizon. All archaeological work was carried out in accordance with the specification. A single context recording system was used to record the deposits, and context recording numbers were assigned to all deposits for recording purposes.

All archaeological work was carried out in accordance with KCC, SWAT and ClfA standards and guidance. According to the specification the evaluation will comprise 29 machine excavated trenches (measuring between 10m and 25m) in a layout agreed with the County Archaeologist.

There will also be an allowance of c.30m of contingency trenching which could be used if it would help address the aims set out above. Contingency trenching can be activated following agreement with the County Archaeologist. Care will be taken to ensure that unnecessary additional excavation does not take place where archaeological deposits or structures are exposed; in particular, there is to be no reduction of the underlying soils to further enhance archaeological features.

As the principal aim of the evaluation is to determine the continuation of the known archaeological landscape, excavation of features will not take place in lieu of further archaeological investigation (archaeological Strip, Map and Sample). Recovery of any surface finds will be put in place to facilitate spot-dating.

8. Monitoring

Curatorial monitoring was available during the course of the evaluation.

9. Results

Trench 1

The plan is recorded in Figure 2. The trench lay on an NE-SW alignment and measured approximately 10m by 1.80m.

The natural (104) was exposed at a depth of between 0.52m-0.71m (max 2.46m aOD) and was overlaid by Topsoil (101), subsoil (102) and a layer of light-mid orange-brown silt (103). No archaeology was revealed in this trench.

Trench 2

The plan is recorded in Figure 2 and 3. The trench lay on an NW-SE alignment and measured approximately 25m by 1.80m.

The natural (208) was exposed at a depth of between 0.51m-0.67m (max 2.57m aOD) and was overlaid by Topsoil (201), subsoil (202) and a layer of light-mid orange-brown silt (203).

The layer of silt (203) sealed two archaeological features. Feature [205] was curvilinear that continued beyond the limits of the trench and may represent the ring-ditch of a Barrow (four of which have already been discovered, including one c.75m to the north of Trench 2). The fill (204) comprised of dark brown silty brickearth that contained burnt flint, fired clay and produced EP or HP grog-tempered ware dating to c.2800-2300 BC. The second feature [207] was a linear that merged with curvilinear [205] and also continued beyond the limits of the trench. It had a NE-SW alignment and continued beyond the limits of the trench. The fill (206) comprised of mid-dark grey-brown silty brickearth that also contained burnt flint and produced EP or HP grog-tempered ware dating to c.2800-2300 BC.

Trench 3

The plan is recorded in Figure 2 and Plate 1. The trench lay on an NE-SW alignment and measured approximately 25m by 1.80m.

The natural (306) was exposed at a depth of between 0.50m-0.69m (max 2.89m aOD) and was overlaid by Topsoil (301), subsoil (302) and a layer of light-mid orange-brown silt (303).

The layer of silt (303) sealed one archaeological feature, a narrow linear [305] that had a NW-SE alignment and continued beyond the limits of the trench. The fill (304) comprised of mid grey-brown very silty brickearth.

Trench 4

The plan is recorded in Figure 2. The trench lay on an NW-SE alignment and measured approximately 25m by 1.80m.

The natural (404) was exposed at a depth of between 0.54m-0.71m (max 2.89m aOD) and was overlaid by Topsoil (401), subsoil (402) and a layer of light-mid orange-brown silt (403). A 3m wide pipeline trench, that had been recently cut, was exposed. No archaeology was revealed in this trench.

Trench 5

The plan is recorded in Figure 2. The trench lay on an NW-SE alignment and measured approximately 25m by 1.80m.

The natural (506) was exposed at a depth of between 0.55m-0.67m (max 2.95m aOD) and was overlaid by Topsoil (501), subsoil (502) and a layer of light-mid orange-brown silt (503).

The layer of silt (503) sealed one archaeological feature, a narrow linear [505] that had a NE-SW alignment and continued beyond the limits of the trench. The fill (504) comprised of light grey-brown silty brickearth.

Trench 6

The plan is recorded in Figure 2. The trench lay on an NE-SW alignment and measured approximately 25m by 1.80m.

The natural (606) was exposed at a depth of between 0.60m-0.61m (max 3.11m aOD) and was overlaid by Topsoil (601), subsoil (602) and a layer of light-mid orange-brown silt (603).

The layer of silt (603) sealed one archaeological feature, a narrow linear [605] that had a NE-SW alignment and continued beyond the limits of the trench (and is most likely, a continuation of [505]). The fill (604) comprised of light grey-brown silty brickearth.

Trench 7

The plan is recorded in Figure 2. The trench lay on an NW-SE alignment and measured approximately 12.5m by 1.80m.

The natural (706) was exposed at a depth of between 0.53m-0.84m (max 3.18m aOD) and was overlaid by Topsoil (701), subsoil (702) and a layer of light-mid orange-brown silt (703).

The layer of silt (703) sealed one archaeological feature, a narrow linear [705] that had a NE-SW alignment and continued beyond the limits of the trench. The fill (704) comprised of mid grey-brown silty brickearth that produced grog-tempered ware dating to c.2800-2300 BC.

Trench 8

The plan is recorded in Figures 2 and 4. The trench lay on an NE-SW alignment and measured approximately 25m by 1.80m.

The natural (810) was exposed at a depth of between 0.54m-0.68m (max 2.27m aOD) and was overlaid by Topsoil (801), subsoil (802) and a layer of light-mid orange-brown silt (803).

The layer of silt (803) sealed three archaeological features that continued beyond the limits of the trench. Linear [805] was narrow and had a NE-SW alignment (and is most likely, a continuation of [505] and [605]). The fill (804) comprised of light grey-brown silty brickearth that produced worked flint. The second feature [807] was also a narrow linear that had a NW-SE alignment. The fill (806) comprised of mid brown silty brickearth.

The third feature [809] was also a narrow linear and was parallel with [807]. The fill (808) comprised of dark grey-brown silty brickearth.

Trench 9

The plan is recorded in Figures 2 and 5. The trench lay on an NW-SE alignment and measured approximately 20m by 1.80m.

The natural (908) was exposed at a depth of between 0.58m-0.78m (max 2.45m aOD) and was overlaid by Topsoil (901), subsoil (902) and a layer of light-mid orange-brown silt (903).

The layer of silt (903) sealed two archaeological features. Feature [205] was a linear terminus that had NW-SE alignment that continued beyond the NW limit of the trench. The fill (904) comprised of mid brown silty brickearth. The second feature [907] was also a linear terminus aligned NW-SE and was situated opposite [905]. The fill (906) comprised of light grey-brown silty brickearth. Both features were clearly part of the same linear system.

Trench 10

The plan is recorded in Figure 2. The trench lay on an NE-SW alignment and measured approximately 10m by 1.80m.

The natural (1004) was exposed at a depth of between 0.54m-0.70m (max 2.15m aOD) and was overlaid by Topsoil (1001), subsoil (1002) and a layer of light-mid orange-brown silt (1003). No archaeology was revealed in this trench.

Trench 11

The plan is recorded in Figure 2. The trench lay on an NE-SW alignment and measured approximately 20m by 1.80m.

The natural (1104) was exposed at a depth of between 0.66m-0.90m (max 2.19m aOD) and was overlaid by Topsoil (1101), subsoil (1102) and a layer of light-mid orange-brown silt (1103). No archaeology was revealed in this trench.

Trench 12

The plan is recorded in Figure 2 and Plate 2. The trench lay on an NE-SW alignment and measured approximately 25m by 1.80m.

The natural (1206) was exposed at a depth of between 0.59m-0.84m (max 2.44m aOD) and was overlaid by Topsoil (1201), subsoil (1202) and a layer of light-mid orange-brown silt (1203).

The layer of silt (1203) sealed one archaeological feature, a narrow linear [1205] that had a NW-SE alignment and continued beyond the limits of the trench. The fill (1204) comprised of mid brown silty brickearth.

Trench 13

The plan is recorded in Figure 2. The trench lay on an NE-SW alignment and measured approximately 25m by 1.80m.

The natural (1306) was exposed at a depth of between 0.63m-0.66m (max 2.72m aOD) and was overlaid by Topsoil (1301), subsoil (1302) and a layer of light-mid orange-brown silt (1303).

The layer of silt (1303) sealed one archaeological feature, a linear [1305] that had a N-S alignment and continued beyond the limits of the trench. The fill (1304) comprised of dark brown silty brickearth that produced EP or HP grog-tempered ware dating to c.2800-2300 BC.

An old service trench was also exposed.

Trench 14

The plan is recorded in Figure 2. The trench lay on an NE-SW alignment and measured approximately 25m by 1.80m.

The natural (1403) was exposed at a depth of between 0.50m-0.78m (max 2.76m aOD) and was overlaid by Topsoil (1400), subsoil (1401) and a layer of light-mid orange-brown silt (1402). No archaeology was revealed in this trench.

Trench 15

The plan is recorded in Figure 2. The trench lay on an NW-SE alignment and measured approximately 25m by 1.80m.

The natural (1503) was exposed at a depth of between 0.66m-0.77m (max 2.74m aOD) and was overlaid by Topsoil (1500), subsoil (1501) and a layer of light-mid orange-brown silt (1502). No archaeology was revealed in this trench.

Trench 16

The plan is recorded in Figure 2. The trench lay on an NE-SW alignment and measured approximately 12.5m by 1.80m.

The natural (1603) was exposed at a depth of between 0.65m-0.73m (max 2.20m aOD) and was overlaid by Topsoil (1600), subsoil (1601) and a layer of light-mid orange-brown silt (1602). No archaeology was revealed in this trench.

Trench 17

The plan is recorded in Figure 2. The trench lay on an NW-SE alignment and measured approximately 25m by 1.80m.

The natural (1703) was exposed at a depth of between 0.53m-0.62m (max 2.17m aOD) and was overlaid by Topsoil (1700), subsoil (1701) and a layer of light-mid orange-brown silt (1702). No archaeology was revealed in this trench.

Trench 18

The plan is recorded in Figure 2. The trench lay on an NE-SW alignment and measured approximately 10m by 1.80m.

The natural (1807) was exposed at a depth of between 0.69m-0.97m (max 1.82m aOD) and was overlaid by Topsoil (1800), subsoil (1801) and a layer of light-mid orange-brown silt (1802).

The layer of silt (1802) sealed two archaeological features. Feature [1804] was a wide linear that had NW-SE alignment that continued beyond the limits of the trench. The fill (1803) comprised of mid grey-brown silty brickearth that contained occasional charcoal and produced an unfinished, polished Mesolithic-Neolithic mace/hammer (Plate 3). The second feature [1806] was a linear terminus, also aligned NW-SE and continued beyond the SW limit of the trench. The fill (1805) comprised of light-mid grey-brown silty brickearth.

Trench 19

The plan is recorded in Figures 2 and 6 and Plate 4. The trench lay on a NW-SE alignment and measured approximately 25m by 1.80m.

The natural (1919) was exposed at a depth of between 0.69m-0.97m (max 1.82m aOD) and was overlaid by Topsoil (1900), subsoil (1901) and a layer of light-mid orange-brown silt (1902). The layer of silt (1902) sealed eight archaeological features. Feature [1904] was an ovate-shaped pit. The fill (1903) comprised of light grey-orange-brown silty brickearth that contained occasional charcoal and produced pottery (too fragmentary for recovery). The second feature [1906] was either a linear terminus or a pit and continued beyond the SW limit of the trench. The fill (1905) comprised of mid grey-brown silty brickearth that contained occasional charcoal and produced grog-tempered ware dating to c.2800-2300 BC. The third feature [1908] was a narrow linear that had a NE-SW alignment and continued beyond the limits of the trench. The fill (1907) comprised of mid grey-brown silty brickearth that contained occasional charcoal and produced grog-tempered ware dating to c.2800-2300 BC. The fourth feature [1910] was a narrow linear terminus that also had a NE-SW alignment and continued beyond the SW limit of the trench. The fill (1909) comprised of mid grey-brown silty brickearth that contained occasional charcoal. The fifth feature [1912] was a linear that had a NE-SW alignment and also continued beyond the limits of the trench. The fill (1911) comprised of light-mid grey-brown silty brickearth that contained occasional charcoal. The sixth feature [1914] was also a linear feature. Again, it had a NE-SW alignment and continued beyond the limits of the trench. The fill (1913) comprised of mid grey-brown silty brickearth that produced grog-tempered ware. The seventh feature [1916] was another linear on a NE-SW alignment that also continued beyond the limits of the trench. The fill (1915) comprised of light-mid grey-brown silty brickearth that contained occasional charcoal and produced pottery (too fragmentary for recovery). The eighth and final feature [1918] was a linear that had N-S alignment and continued beyond the limits of the trench. The fill (1917) comprised of light-mid grey-brown silty brickearth.

Trench 20

The plan is recorded in Figures 2 and 7 and Plate 5. The trench lay on an NNE-SSW alignment and measured approximately 25m by 1.80m.

The natural (2010) was exposed at a depth of between 0.55m-0.69m (max 2.10m aOD) and was overlaid by Topsoil (2000), subsoil (2001) and a layer of light-mid orange-brown silt (2002).

The layer of silt (2002) sealed four archaeological features. Feature [2004] was a wide linear that had NW-SE alignment that continued beyond the limits of the trench. The fill (2003) comprised of light grey silty brickearth that produced grog-tempered ware dating to c.2800-2300 BC or c.100-0BC alternatives. The second feature [2006] was a linear that was also aligned NW-SE and continued beyond the limits of the trench. The fill (2005) comprised of light-dark grey silty brickearth. The third feature [2008] was another linear with a NW-SE alignment and also continued beyond the limits of the trench. The fill (2007) comprised of light grey silty brickearth that produced pottery (too fragmentary for recovery). The fourth feature [2010] was a linear with an almost E-W alignment. The fill (2009) comprised of light-mid grey silty brickearth.

Trench 21

The plan is recorded in Figure 2. The trench lay on an NW-SE alignment and measured approximately 25m by 1.80m.

The natural (2103) was exposed at a depth of between 0.53m-1.15m (max 2.36m aOD) and was overlaid by Topsoil (2100), subsoil (2101) and a layer of light-mid orange-brown silt (2102). No archaeology was revealed in this trench.

Trench 22

The plan is recorded in Figure 2. The trench lay on an NE-SW alignment and measured approximately 25m by 1.80m.

The natural (2207) was exposed at a depth of between 0.51m-0.81m (max 2.27m aOD) and was overlaid by Topsoil (2200), subsoil (2201) and a layer of light-mid orange-brown silt (2202).

The layer of silt (2202) sealed two archaeological features. Feature [2204] was a wide linear that had NW-SE alignment that continued beyond the limits of the trench. The fill (2203) comprised of mid grey-brown silty brickearth that contained occasional charcoal. The second feature [2206] was also a linear that was aligned NW-SE, may have truncated [2204] and continued beyond the limits of the trench. The fill (2205) comprised of dark grey-black silty brickearth. The linear was also observed in trench 23 [2310].

Trench 23

The plan is recorded in Figures 2 and 8, and Plate 6. The trench lay on an NE-SW alignment and measured approximately 25m by 1.80m.

The natural (2311) was exposed at a depth of between 0.64m-0.70m (max 2.00m aOD) and was overlaid by Topsoil (2300), subsoil (2301) and a layer of light-mid orange-brown silt (2302).

The layer of silt (2302) sealed four archaeological features. Feature [2304] was an ovate-shaped post hole that had NE-SW. The fill (2303) comprised of mid grey silty brickearth that produced pottery (too fragmentary for recovery). The second feature [2306] was either a linear terminus or a pit that had a NW-SE alignment and continued beyond the limits of the trench. The fill (2305) comprised of mid-dark grey-brown silty brickearth that contained occasional charcoal. The third feature [2308] was an irregular-shaped linear that had an E-W alignment and continued beyond the SE limit of the trench. The fill (2307) comprised of mid-dark grey silty brickearth that produced pottery (too fragmentary for recovery).

The fourth feature [2310] was a linear that had a NW-SE alignment and continued beyond the limits of the trench. The fill (2309) comprised of mid dark grey silty brickearth that contained occasional charcoal. The linear was also observed in Trench 22 [2206].

Trench 24

The plan is recorded in Figure 2. The trench lay on an NW-SE alignment and measured approximately 25m by 1.80m.

The natural (2405) was exposed at a depth of between 0.45m-0.53m (max 2.67m aOD) and was overlaid by Topsoil (2400), subsoil (2401) and a layer of light-mid orange-brown silt (2402).

The layer of silt (2402) sealed one archaeological feature. Feature [2404] was a linear terminus that had NE-SW alignment that continued beyond the SW limit of the trench. The

fill (2403) comprised of dark grey silty brickearth that produced pottery (too fragmentary for recovery).

Trench 25

The plan is recorded in Figure 2 and Plate 7. The trench lay on an NE-SW alignment and measured approximately 25m by 1.80m.

The natural (2509) was exposed at a depth of between 0.63m-0.65m (max 1.70m aOD) and was overlaid by Topsoil (2500), subsoil (2501) and a layer of light-mid orange-brown silt (2502).

The layer of silt (2502) sealed three archaeological features. Feature [2504] was a circular-shaped post hole. The fill (2503) comprised of dark grey silty brickearth. The second feature [2506] was an oval-shape pit that had an E-W alignment. The fill (2505) comprised of mid grey-brown silty brickearth that produced pottery (too fragmentary for recovery). The third feature [2508] was a linear that had a NW-SE alignment and continued beyond the limits of the trench. The fill (2507) comprised of mid-dark grey silty brickearth that contained occasional charcoal. The linear was also observed in trench 26 [2604] and trench 29 [2904].

Trench 26

The plan is recorded in Figure 2 and Plate 8. The trench lay on an NE-SW alignment and measured approximately 10m by 1.80m.

The natural (2605) was exposed at a depth of between 0.61m-0.70m (max 2.14m aOD) and was overlaid by Topsoil (2600), subsoil (2601) and a layer of light-mid orange-brown silt (2602).

The layer of silt (2602) sealed one archaeological feature. Feature [2604] was a linear that had NW-SE alignment that continued beyond the limits of the trench. The fill (2603) comprised of mid-dark grey-brown silty brickearth that contained occasional charcoal. The linear was also observed in trench 25 [2508] and trench 29 [2904].

Trench 27

The plan is recorded in Figures 2 and 9 and Plate 9. The trench lay on an NNE-SSW alignment and measured approximately 25m by 1.80m.

The natural (2707) was exposed at a depth of between 0.59m-0.64m (max 2.50m aOD) and was overlaid by Topsoil (2700), subsoil (2701) and a layer of light-mid orange-brown silt (2702).

The layer of silt (2702) sealed two archaeological features. Feature [2704] was a narrow linear terminus that had NE-SW alignment that continued beyond the SW limit of the trench. The fill (2703) comprised of mid grey silty brickearth that produced grog-tempered ware dating to c.2800-2300 BC or c.100-0 BC. The second feature [2706] was an oval-shaped pit, similar to the Neolithic pits previously recorded on Phases 1 and 2 (Plate 10). It had a NW-SE alignment and the fill (2705) comprised of black silty brickearth that contained moderate charcoal and produced grog-tempered ware dating to c.2800-2300 BC or c.100-0 BC.

Trench 28

The plan is recorded in Figures 2 and 10 and Plate 30. The trench lay on an NNE-SSW alignment and measured approximately 25m by 1.80m.

The natural (2809) was exposed at a depth of between 0.51m-0.98m (max 2.28m aOD) and was overlaid by Topsoil (2800), subsoil (2801) and a layer of light-mid orange-brown silt (2802).

The layer of silt (2802) sealed three archaeological features. Feature [2804] was a narrow linear that had NE-SW alignment that continued beyond the NE limit of the trench. The fill (2803) comprised of mid grey-brown silty brickearth. The second feature [2806] was a linear that may have truncated [2804]. Linear [2806] had a NW-SE alignment and continued beyond the limits of the trench. The fill (2805) comprised of mid grey-brown silty brickearth that contained occasional charcoal. The third feature [2808] was also a linear that had an E-W alignment and continued beyond the limits of the trench. The fill (2807) comprised of mid grey-brown silty brickearth that contained occasional charcoal.

Trench 29

The plan is recorded in Figure 2 and Plate 31. The trench lay on an NE-SW alignment and measured approximately 25m by 1.80m.

The natural (2905) was exposed at a depth of between 0.70m-0.80m (max 2.35m aOD) and was overlaid by Topsoil (2900), subsoil (2901) and a layer of light-mid orange-brown silt (2902).

The layer of silt (2902) sealed one archaeological feature. Feature [2904] was a linear that had NW-SE alignment that continued beyond the limits of the trench. The fill (2903) comprised of mid grey-brown silty brickearth. The linear was also observed in trench 25 [2508] and trench 26 [2604].

10. Discussion

The *in-situ* features exposed during the evaluation occurred in the following trenches.

Trench 2- curvilinear [205] and linear [207]

Trench 3- Linear [305]

Trench 5- linear [505]

Trench 6- linear [605]

Trench 7- linear [705]

Trench 8- linears [805], [807] and [809]

Trench 9- linears [905] and [907]

Trench 12- linear [1205]

Trench 13- linear [1305]

Trench 18- linears [1804] and [1806]

Trench 19- pit [1904], pit/linear [1906], linears [1908], [1910], [1912], [1914], [1916] and [1918]

Trench 20- linears [2004], [2006], [2008] and [2010]

Trench 22- linears [2204] and [2206]

Trench 23- post hole [2304], pit/linear [2306], linears [2308] and [2310]

Trench 24- linear [2404]

Trench 25- post hole [2504], pit [2506], linear [2508]

Trench 26- linear [2604]

Trench 27- linear [2704], pit [2706]

Trench 28- linears [2804], [2806] and [2808]

Trench 29- linear [2904]

The proposed Phase 3 development can therefore be judged to pose a threat to significant archaeological remains.

11. Finds

Finds comprised of pottery from features [205], [304], [705], [1305], [1906], [1908], [1910], [1914], [2004], [2704], [2706]; worked flint from features [505], [805] [2004] and a Mesolithic-Neolithic unfinished polished Mace/Hammer from [1804] (Plate 3).

12. Conclusion

The evaluation trenches at the proposed development site revealed important archaeological features and artefacts.

The archaeological evaluation has been successful in fulfilling the primary aims and objectives of the Specification. A common stratigraphic sequence was recognised across the site that comprised of a series of linear field systems and a series of pits and post holes, which are a continuation of the archaeological landscape observed during the SMS of Phases 1 and 2 between 2013 and 2016.

Therefore, this evaluation has been successful in fulfilling the aims and objectives as set out in the Planning Condition and the Archaeological Specification.

13. Acknowledgements

SWAT Archaeology would like to thank the client, Persimmon Homes Southeast, for commissioning the project. Thanks are also extended to Ben Found, Heritage Officer, Kent County Council. Site survey and illustrations were produced by Bartek Cichy. The fieldwork was undertaken by Simon Holmes and Dan Latus and the report was written by Simon Holmes MA

20/03/2018

14. References

Entec (2010) *Desk-Based Assessment of Land at Church Lane, Deal, Kent*

Headland Archaeology (2013) *Church Lane, Deal, Kent; Results of an Archaeological Evaluation*

Institute for Field Archaeologists (IfA), Rev (2014). *Standard and Guidance for archaeological field evaluation*

SWAT Archaeology (30/03/17) *Written Scheme of Investigation for an Archaeological Evaluation*

SWAT Archaeology (2014) *Interim Report on the Archaeological Strip, Map and Sample of Phase 1 at Sholden Gap, Church Lane, Sholden, Deal, Kent*

SWAT Archaeology (2018) *Archaeological Assessment of Phase Two of Church Lane, Deal, Sholden, Kent*

Trench 1	Dimensions: 10m x 1.8m, 0.52m – 0.71m deep, NE-SW aligned Ground Level at NE end: 3.04m aOD Ground Level at SW end: 3.17m aOD		
Context	Description	Interpretation	Depth (m)
101	Dark grey brown clayey silt with slight sand content and frequent roots	Topsoil	0.00-0.30
102	Grey mid brown silty clay, moderate roots	Subsoil	0.30-0.50
103	Light grey brown clayey silt	Silt Horizon	0.50-0.60
104	Orange brown silty brickearth	Natural	+0.60

Trench 2	Dimensions: 25m x 1.8m, 0.51m-0.67m deep, NW-SE aligned Ground Level at NW end: 3.40m aOD Ground Level at SE end: 3.24m aOD		
Context	Description	Interpretation	Depth (m)
201	Dark grey brown clayey silt with slight sand content and frequent roots	Topsoil	0.00-0.30
202	Grey mid brown silty clay, moderate roots	Subsoil	0.30-0.55
203	Light grey brown clayey silt	Silt Horizon	0.55-0.60
204	Dark brown silty clay with fired clay, burnt flint and pot	Fill of Curvilinear 205	0.60
205	Length: 8m. Width: 0.50m.	Cut of Curvilinear	0.60
206	Mid-dark grey brown clayey silt with burnt flint and pot	Fill of Linear	0.60
207	Length: +1.80m. Width: 1m.	Cut of Linear	0.60
208	Orange brown silty brickearth	Natural	0.60

Trench 3	Dimensions: 25m x 1.8m, 0.50m-0.69m deep, NE-SW aligned Ground Level at NE end: 3.39m aOD Ground Level at SW end: 3.72m aOD		
Context	Description	Interpretation	Depth (m)
301	Dark grey brown clayey silt with slight sand content and frequent roots	Topsoil	0.00-0.20
302	Grey mid brown silty clay, moderate roots	Subsoil	0.20-0.32
303	Light grey brown clayey silt	Silt Horizon	0.32-0.55
304	Mid grey brown silty clay	Fill of Linear 305	0.55-0.60
305	Length: +1.80m. Width: 0.25m.	Cut of Linear	0.60
306	Orange brown silty brickearth	Natural	0.60

Trench 4	Dimensions: 25m x 1.8m, 0.54m-0.71m deep, NW-SE aligned Ground Level at NW end: 3.60m aOD Ground Level at SE end: 3.84m aOD		
Context	Description	Interpretation	Depth (m)
401	Dark grey brown clayey silt with slight sand content and frequent roots	Topsoil	0.00-0.30
402	Grey mid brown silty clay, moderate roots	Subsoil	0.30-0.45
403	Light grey brown clayey silt	Silt Horizon	0.45-0.55
404	Orange brown silty brickearth	Natural	0.55-0.70

Trench 5	Dimensions: 25m x 1.8m, 0.55m-0.67m deep, NW-SE aligned Ground Level at NW end: 3.59m aOD Ground Level at SE end: 3.62m aOD		
Context	Description	Interpretation	Depth (m)
501	Dark grey brown clayey silt with slight sand content and frequent roots	Topsoil	0.00-0.30
502	Grey mid brown silty clay, moderate roots	Subsoil	0.30-0.46
503	Light grey brown clayey silt	Silt Horizon	0.46-0.62
504	Light grey brown silty clay	Fill of Linear 505	0.62-0.72
505	Length: +1.80m. Width: 0.30m.	Cut of Linear	0.72
506	Orange brown silty brickearth	Natural	0.72

Trench 6	Dimensions: 25m x 1.8m, 0.61m deep, NE-SW aligned Ground Level at NE end: 3.71m aOD Ground Level at SW end: 3.91m aOD		
Context	Description	Interpretation	Depth (m)
601	Dark grey brown clayey silt with slight sand content and frequent roots	Topsoil	0.00-0.30
602	Grey mid brown silty clay, moderate roots	Subsoil	0.30-0.38
603	Light grey brown clayey silt	Silt Horizon	0.38-0.49
604	Light grey brown silty clay	Fill of Linear 605	0.49-0.56
605	Length: +1.50m. Width: 0.25m.	Cut of Linear	0.56
606	Orange brown silty brickearth	Natural	0.56

Trench 7	Dimensions: 20m x 1.8m, 0.53m-0.84m deep, NW-SE aligned Ground Level at NW end: 3.81m aOD Ground Level at SE end: 4.02m aOD		
Context	Description	Interpretation	Depth (m)
701	Dark grey brown clayey silt with slight sand content and frequent roots	Topsoil	0.00-0.30
702	Grey mid brown silty clay, moderate roots	Subsoil	0.30-0.40
703	Light grey brown clayey silt	Silt Horizon	0.40-0.58
704	Mid grey brown silty clay with pot	Fill of Linear 705	0.58
705	Length: +1.80m. Width: 0.30m	Cut of Linear	0.58
706	Orange brown silty brickearth	Natural	0.58

Trench 8	Dimensions: 25m x 1.8m, 0.54m-0.68m deep, NE-SW aligned Ground Level at NE end: 2.95m aOD Ground Level at SW end: 3.47m aOD		
Context	Description	Interpretation	Depth (m)
801	Dark grey brown clayey silt with slight sand content and frequent roots	Topsoil	0.00-0.30
802	Grey mid brown silty clay, moderate roots	Subsoil	0.30-0.46
803	Light grey brown clayey silt	Silt Horizon	0.46-0.66
804	Light grey brown silty clay with worked flint	Fill of Linear 805	0.66
805	Length: +4m. Width: 0.30m.	Cut of Linear	0.66
806	Mid brown silty clay	Fill of Linear 807	0.66
807	Length: +1.80m. Width: 0.30m.	Cut of Linear	0.66
808	Dark grey brown silty clay	Fill of Linear 809	0.66
809	Length: +1.80m. Width: 0.25m.	Cut of Linear	0.66
810	Orange brown silty brickearth	Natural	0.66

Trench 9	Dimensions: 25m x 1.8m, 0.58m-0.78m deep, NW-SE aligned Ground Level at NW end: 3.18m aOD Ground Level at SE end: 3.23m aOD		
Context	Description	Interpretation	Depth (m)
901	Dark grey brown clayey silt with slight sand content and frequent roots	Topsoil	0.00-0.35
902	Grey mid brown silty clay, moderate roots	Subsoil	0.35-0.45
903	Light grey brown clayey silt	Silt Horizon	0.45-0.64
904	Mid brown silty clay	Fill of Linear 905	0.64-0.70
905	Length: +3.50m. Width: 0.25m.	Cut of Linear	0.70
906	Light grey brown silty clay	Fill of Linear 907	0.70
907	Length: +8m. Width: 0.25m.	Cut of Linear	0.70
908	Orange brown silty brickearth	Natural	0.70

Trench 10	Dimensions: 10m x 1.8m, 0.54m-0.70m deep, NE-SW aligned Ground Level at NE end: 2.85m aOD Ground Level at SW end: 3.03m aOD		
Context	Description	Interpretation	Depth (m)
1001	Dark grey brown clayey silt with slight sand content and frequent roots	Topsoil	0.00-0.30
1002	Grey mid brown silty clay, moderate roots	Subsoil	0.30-0.43
1003	Light grey brown clayey silt	Silt Horizon	0.43-0.55
1004	Orange brown silty brickearth	Natural	0.55-0.67

Trench 11	Dimensions: 20m x 1.8m, 0.66m-0.90 deep, NE-SW aligned Ground Level at NE end: 2.85m aOD Ground Level at SW end: 3.11m aOD		
Context	Description	Interpretation	Depth (m)
1101	Dark grey brown clayey silt with slight sand content and frequent roots	Topsoil	0.00-0.30
1102	Grey mid brown silty clay, moderate roots	Subsoil	0.30-0.43
1103	Light grey brown clayey silt	Silt Horizon	0.43-0.57
1104	Orange brown silty brickearth	Natural	0.57-0.64

Trench 12	Dimensions: 25m x 1.8m, 0.59m-0.84m deep, NE-SW aligned Ground Level at NE end: 3.03m aOD Ground Level at SW end: 3.60m aOD		
Context	Description	Interpretation	Depth (m)
1201	Dark grey brown clayey silt with slight sand content and frequent roots	Topsoil	0.00-0.40
1202	Grey mid brown silty clay, moderate roots	Subsoil	0.40-0.63
1203	Light grey brown clayey silt	Silt Horizon	0.63-0.86
1204	Mid brown silty clay	Fill of Linear 1205	0.86
1205	Length: +1.80m. Width: 0.25m	Cut of Linear	0.86
1206	Orange brown silty brickearth	Natural	0.86

Trench 13	Dimensions: 25m x 1.8m, 0.63m-0.66m deep, NE-SW aligned Ground Level at NE end: 3.35m aOD Ground Level at SW end: 3.97m aOD		
Context	Description	Interpretation	Depth (m)
1301	Dark grey brown clayey silt with slight sand content and frequent roots	Topsoil	0.00-0.30
1302	Grey mid brown silty clay, moderate roots	Subsoil	0.30-0.45
1303	Light grey brown clayey silt	Natural	0.45-0.61
1304	Dark brown silty clay with pot	Fill of Linear 1305	0.61-0.70
1305	Length: +2m. Width: +1.30m.	Cut of Linear	0.70
1306	Orange brown silty brickearth	Natural	0.70

Trench 14	Dimensions: 25m x 1.8m, 0.63m-0.85m deep, NE-SW aligned Ground Level at NE end: 3.26m aOD Ground Level at SW end: 3.71m aOD		
Context	Description	Interpretation	Depth (m)
1400	Dark grey black loamy silty soil frequent roots	Topsoil	0.00-0.34
1401	Mid grey silty brickearth	Subsoil	0.34-0.59
1402	Light mid orange brown silt	Silt Horizon	0.59-0.89
1403	Orange brown brickearth	Natural	0.89

Trench 15	Dimensions: 25m x 1.8m, 0.68m-0.78m deep, NW-SE aligned Ground Level at NW end: 3.53m aOD Ground Level at SE end: 3.40m aOD		
Context	Description	Interpretation	Depth (m)
1500	Dark grey black loamy silty soil frequent roots	Topsoil	0.00-0.27
1501	Mid grey silty brickearth	Subsoil	0.27-0.52
1502	Light mid orange brown silt	Silt Horizon	0.52-0.78
1503	Orange brown brickearth	Natural	0.78

Trench 16	Dimensions: 25m x 1.8m, 0.76m-0.78m deep, NE-SW aligned Ground Level at NW end: 2.85m aOD Ground Level at SE end: 3.19m aOD		
Context	Description	Interpretation	Depth (m)
1600	Dark grey black loamy silty soil frequent roots	Topsoil	0.00-0.26
1601	Mid grey silty brickearth	Subsoil	0.26-0.58
1602	Light mid orange brown silt	Silt Horizon	0.58-0.74
1603	Orange brown brickearth	Natural	0.74

Trench 17	Dimensions: 25m x 1.8m, 0.64m-0.76m deep, NW-SE aligned Ground Level at NW end: 2.89m aOD Ground Level at SE end: 2.70m aOD		
Context	Description	Interpretation	Depth (m)
1700	Dark grey black loamy silty soil frequent roots	Topsoil	0.00-0.20
1701	Mid grey silty brickearth	Subsoil	0.20-0.52
1702	Light mid orange brown silt	Silt Horizon	0.52-0.64
1703	Orange brown brickearth	Natural	0.64

Trench 18	Dimensions: 10m x 1.8m, 0.71m-0.81m deep, NE-SW aligned Ground Level at NE end: 2.79m aOD Ground Level at SW end: 2.63m aOD		
Context	Description	Interpretation	Depth (m)
1800	Dark grey black loamy silty soil frequent roots	Topsoil	0.00-0.29
1801	Mid grey silty brickearth	Subsoil	0.29-0.51
1802	Light mid orange brown silt	Silt Horizon	0.51-0.65
1803	Mid grey brown silty brickearth with charcoal and Mace Head	Fill of Linear 1804	0.65
1804	Length:+2m. Width: 1.25m.	Cut of Linear	0.65
1805	Light mid grey brown silty brickearth	Fill of Linear 1806	0.65
1806	Length: +1.75m. Width: 0.25m.	Cut of Linear	0.65
1807	Orange brown brickearth	Natural	0.65

Trench 19	Dimensions: 25m x 1.8m, 0.69m-0.97m deep, NW-SE aligned Ground Level at NW end: 2.79m aOD Ground Level at SE end: 2.82m aOD		
Context	Description	Interpretation	Depth (m)
1900	Dark grey black loamy silty soil frequent roots	Topsoil	0.00-0.24
1901	Mid grey silty brickearth	Subsoil	0.24-0.28
1902	Light mid orange brown silt	Silt Horizon	0.28-0.53
1903	Light grey orange brown silty brickearth with charcoal and pot	Fill of Pit 1904	0.53
1904	Diameter: 1.25m.	Cut of Pit	0.53
1905	Mid grey brown silty brickearth with charcoal and pot	Fill of Feature 1906	0.53
1906	Length: +2m. Width: 1.60m.	Cut of Feature	0.53
1907	Mid grey brown silty brickearth with charcoal and pot	Fill of Linear 1908	0.53
1908	Length: +2m. Width: 0.40m.	Cut of Linear	0.53
1909	Mid grey brown silty brickearth with charcoal and pot	Fill of linear 1910	0.53
1910	Length: +1.50m. Width: 0.40m.	Cut of Linear	0.53
1911	Light mid grey brown silty brickearth with charcoal	Fill of Linear 1912	0.53
1912	Length: +3m. Width: 0.80m.	Cut of Linear	0.53
1913	Mid grey brown silty brickearth with pot	Fill of linear 1914	0.53
1914	Length: +1.80m. Width: 0.70m.	Cut of Linear	0.53
1915	Light mid grey brown silty brickearth with charcoal and pot	Fill of Feature 1916	0.53

1916	Length: +1.80m. Width: 2m.	Cut of Feature	0.53
1917	Light mid grey brown silty brickearth	Fill of Linear 1918	0.53
1918	Length: +2.50m. Width: 0.50m.	Cut of Linear	0.53
1919	Orange brown brickearth	Natural	0.53

Trench 20	Dimensions: 25m x 1.8m, 0.56m-0.68m deep, NE-SW aligned Ground Level at NE end: 2.79m aOD Ground Level at SW end: 2.87m aOD		
Context	Description	Interpretation	Depth (m)
2000	Dark grey black loamy silty soil frequent roots	Topsoil	0.00-0.21
2001	Mid grey silty brickearth	Subsoil	0.21-0.36
2002	Light mid orange brown silt	Silt Horizon	0.36-0.54
2003	Light grey silty brickearth with worked flint and pot	Fill of Linear 2004	0.54
2004	Length: +1.80m. Width: +1m.	Cut of Linear	0.54
2005	Light dark grey silty brickearth with worked flint	Fill of Linear 2006	0.54
2006	Length: +2.50m. Width: 0.80m.	Cut of Feature	0.54
2007	Light grey silty brickearth with charcoal and pot	Fill of Linear 2008	0.54
2008	Length: +2m. Width: 1m.	Cut of Linear	0.54
2009	Light mid grey silty brickearth with charcoal and pot	Fill of linear 2010	0.54
2010	Length: +2m. Width: 0.50m.	Cut of Linear	0.54
2011	Orange brown brickearth	Natural	0.54

Trench 21	Dimensions: 25m x 1.8m, 0.62m-0.68m deep, NW-SE aligned Ground Level at NW end: 2.89m aOD Ground Level at SE end: 3.91m aOD		
Context	Description	Interpretation	Depth (m)
2100	Dark grey black loamy silty soil frequent roots	Topsoil	0.00-0.40
2101	Mid grey silty brickearth	Subsoil	0.40-0.55
2102	Light mid orange brown silt	Silt Horizon	0.55-0.64
2103	Orange brown brickearth	Natural	0.64

Trench 22	Dimensions: 25m x 1.8m, 0.55m-0.68m deep, NE-SW aligned Ground Level at NE end: 2.85m aOD Ground Level at SW end: 3.26m aOD		
Context	Description	Interpretation	Depth (m)
2200	Dark grey black loamy silty soil frequent roots	Topsoil	0.00-0.24
2201	Mid grey silty brickearth	Subsoil	0.24-0.40
2202	Light mid orange brown silt	Silt Horizon	0.40-0.56
2203	Mid grey brown silty brickearth with charcoal	Fill of Linear 2204	0.56
2204	Length: +2m. Width: 1.50m.	Cut of Linear	0.56
2205	Dark grey black silty brickearth with worked flint	Fill of Linear 2206	0.56
2206	Length: +2m. Width: 0.50m.	Cut of Linear	0.56
2207	Orange brown brickearth	Natural	0.56

Trench 23	Dimensions: 25m x 1.8m, 0.59m-0.65m deep, NE-SW aligned Ground Level at NE end: 2.70m aOD Ground Level at SW end: 2.89m aOD		
Context	Description	Interpretation	Depth (m)
2300	Dark grey black loamy silty soil frequent roots	Topsoil	0.00-0.29
2301	Mid grey silty brickearth	Subsoil	0.29-0.44
2302	Light mid orange brown silt	Silt Horizon	0.44-0.59
2303	Mid grey silty brickearth with pot	Fill of Pit/Post Hole 2304	0.59
2304	Length: 0.50m. Width: 0.25m.	Cut of Pit/Post Hole	0.59
2305	Mid dark grey brown silty brickearth with charcoal	Fill of Feature 2306	0.59
2306	Length: +1m. Width: 1m.	Cut of Feature	0.59
2307	Mid dark grey silty brickearth with pot	Fill of Linear 2308	0.59
2308	Length: +2m. Width: 0.50m.	Cut of Linear	0.59
2309	Mid dark grey silty brickearth with pot	Fill of linear 2310	0.59
2310	Length: +2m. Width: 0.60m.	Cut of Linear	0.59
2311	Orange brown brickearth	Natural	0.59

Trench 24	Dimensions: 25m x 1.8m, 0.67m-0.72m deep, NW-SE aligned Ground Level at NW end: 3,12m aOD Ground Level at SE end: 3.31m aOD		
Context	Description	Interpretation	Depth (m)
2400	Dark grey black loamy silty soil frequent roots	Topsoil	0.00-0.32
2401	Mid grey silty brickearth	Subsoil	0.32-0.48
2402	Light mid orange brown silt	Silt Horizon	0.48-0.64
2403	Dark grey silty brickearth with pot	Fill of Linear 2404	0.64
2404	Length: +1m. Width: 0.50m.	Cut of Linear	0.64
2405	Orange brown brickearth	Natural	0.64

Trench 25	Dimensions: 25m x 1.8m, 0.63m-0.65m deep, NE-SW aligned Ground Level at NE end: 2.70m aOD Ground Level at SW end: 3.11m aOD		
Context	Description	Interpretation	Depth (m)
2500	Dark grey black loamy silty soil frequent roots	Topsoil	0.00-0.34
2501	Dark grey black loamy silty soil frequent roots	Subsoil	0.34-0.52
2502	Light mid orange brown silt	Silt Horizon	0.52-0.68
2503	Dark grey silty brickearth	Fill of Post Hole 2504	0.68
2504	Diameter: 0.25m	Cut of Post Hole	0.68
2505	Mid grey brown silty brickearth with pot	Fill of Pit 2506	0.68
2506	Length: 0.60m. Width: 0.50m.	Cut of Pit	0.68
2507	Mid dark grey silty brickearth with charcoal	Fill of Linear 2508	0.68
2508	Length: +1.80m. Width: 0.60m.	Cut of Linear	0.68
2509	Orange brown brickearth	Natural	0.68

Trench 26	Dimensions: 10m x 1.8m, 0.62m-0.64m deep, NE-SW aligned Ground Level at NE end: 2.73m aOD Ground Level at SW end: 3.16m aOD		
Context	Description	Interpretation	Depth (m)
2600	Dark grey black loamy silty soil frequent roots	Topsoil	0.00-0.27
2601	Dark grey black loamy silty soil frequent roots	Subsoil	0.27-0.51
2602	Light mid orange brown silt	Silt Horizon	0.51-0.64
2603	Mid dark grey brown silty brickearth with charcoal	Fill of Linear 2604	0.64
2604	Length: +2m. Width: 0.75m.	Cut of Linear	0.64
2605	Orange brown brickearth	Natural	0.64

Trench 27	Dimensions: 25m x 1.8m, 0.50m-0.69m deep, NW-SE aligned Ground Level at NW end: 3.50m aOD Ground Level at SE end: 3.09m aOD		
Context	Description	Interpretation	Depth (m)
2700	Dark grey black loamy silty soil frequent roots	Topsoil	0.00-0.26
2701	Dark grey black loamy silty soil frequent roots	Subsoil	0.26-0.43
2702	Light mid orange brown silt	Silt Horizon	0.43-0.50
2703	Mid grey silty brickearth with pot	Fill of Linear 2704	0.50
2704	Length: +0.75m. Width: 0.30m.	Cut of Linear	0.50
2705	Black silty brickearth with charcoal and pot	Fill of Pit 2706	0.50
2706	Diameter: 1.50m.	Cut of Pit	0.50
2707	Orange brown brickearth	Natural	0.50

Trench 28	Dimensions: 25m x 1.8m, 0.70m-0.88m deep, NE-SW aligned Ground Level at NE end: 2.79m aOD Ground Level at SW end: 3.31m aOD		
Context	Description	Interpretation	Depth (m)
2800	Dark grey black loamy silty soil frequent roots	Topsoil	0.00-0.27
2801	Dark grey black loamy silty soil frequent roots	Subsoil	0.27-0.62
2802	Light mid orange brown silt	Silt Horizon	0.62-0.74
2803	Mid grey brown silty brickearth	Fill of Linear 2804	0.74
2804	Length: +1.50m. Width: 0.25m.	Cut of Linear	0.74
2805	Mid grey brown silty brickearth with charcoal	Fill of Linear 2806	0.74
2806	Length: +2m. Width: 0.80m.	Cut of Pit	0.74
2807	Mid grey brown silty brickearth with charcoal	Fill of Linear 2808	0.74
2808	Length: +4.50m. Width: 1m.	Cut of Linear	0.74
2809	Orange brown brickearth	Natural	0.74

Trench 29	Dimensions: 25m x 1.8m, 0.69m-0.75m deep, NE-SW aligned Ground Level at NE end: 3.05m aOD Ground Level at SW end: 3.41m aOD		
Context	Description	Interpretation	Depth (m)
2900	Dark grey black loamy silty soil frequent roots	Topsoil	0.00-0.32
2901	Dark grey black loamy silty soil frequent roots	Subsoil	0.32-0.60
2902	Light mid orange brown silt	Silt Horizon	0.60-0.75
2903	Mid grey brown silty brickearth	Fill of Linear 2904	0.75
2904	Length: +2m. Width: 0.65m.	Cut of Linear	0.75
2905	Orange brown brickearth	Natural	0.75



Figure 1: Site location map, scale 1:10000.

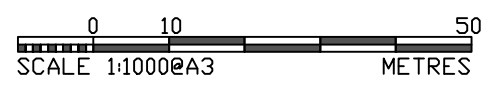
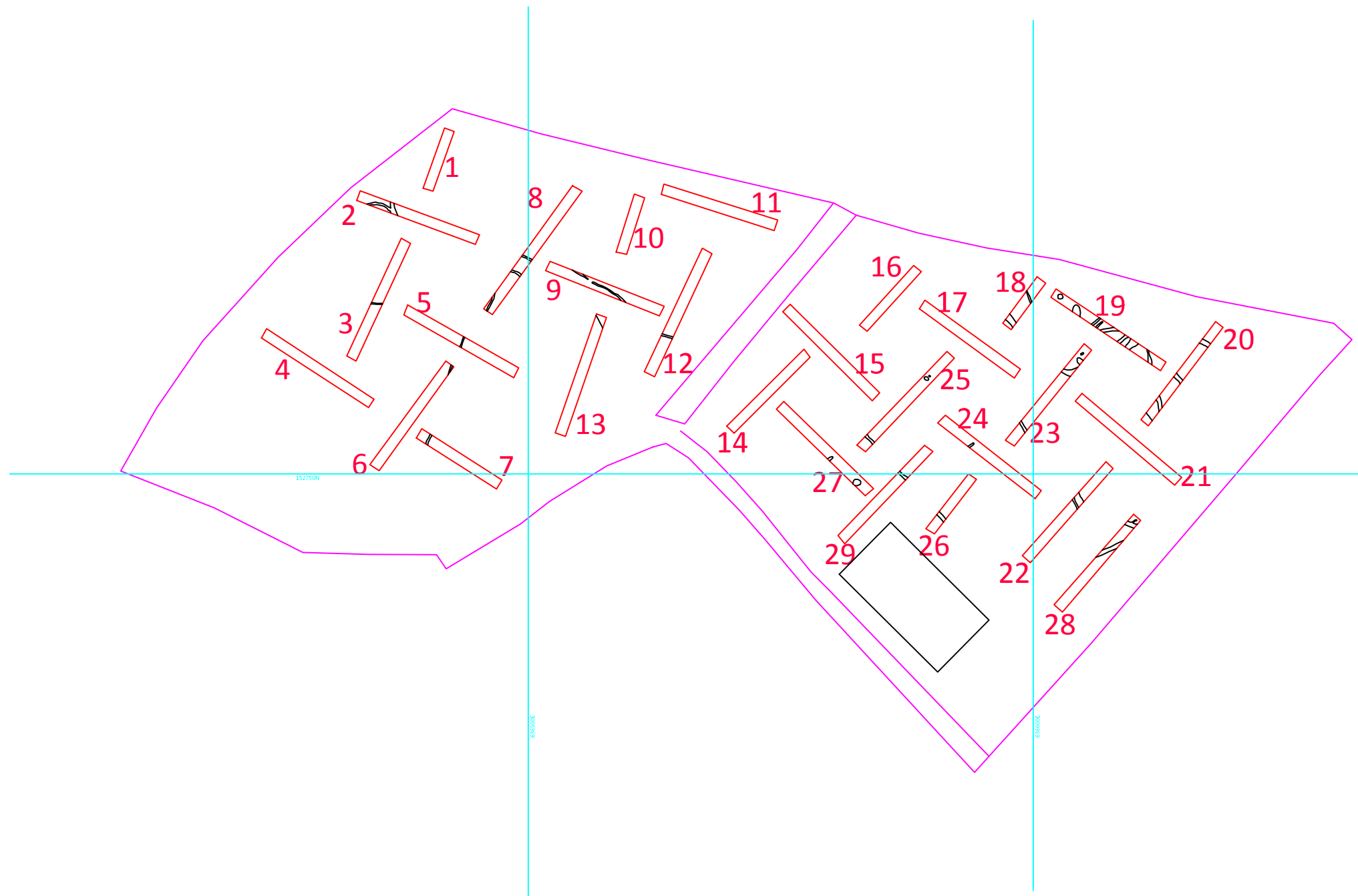

Figure 2: Evaluation phase - Trench location, scale 1:1000

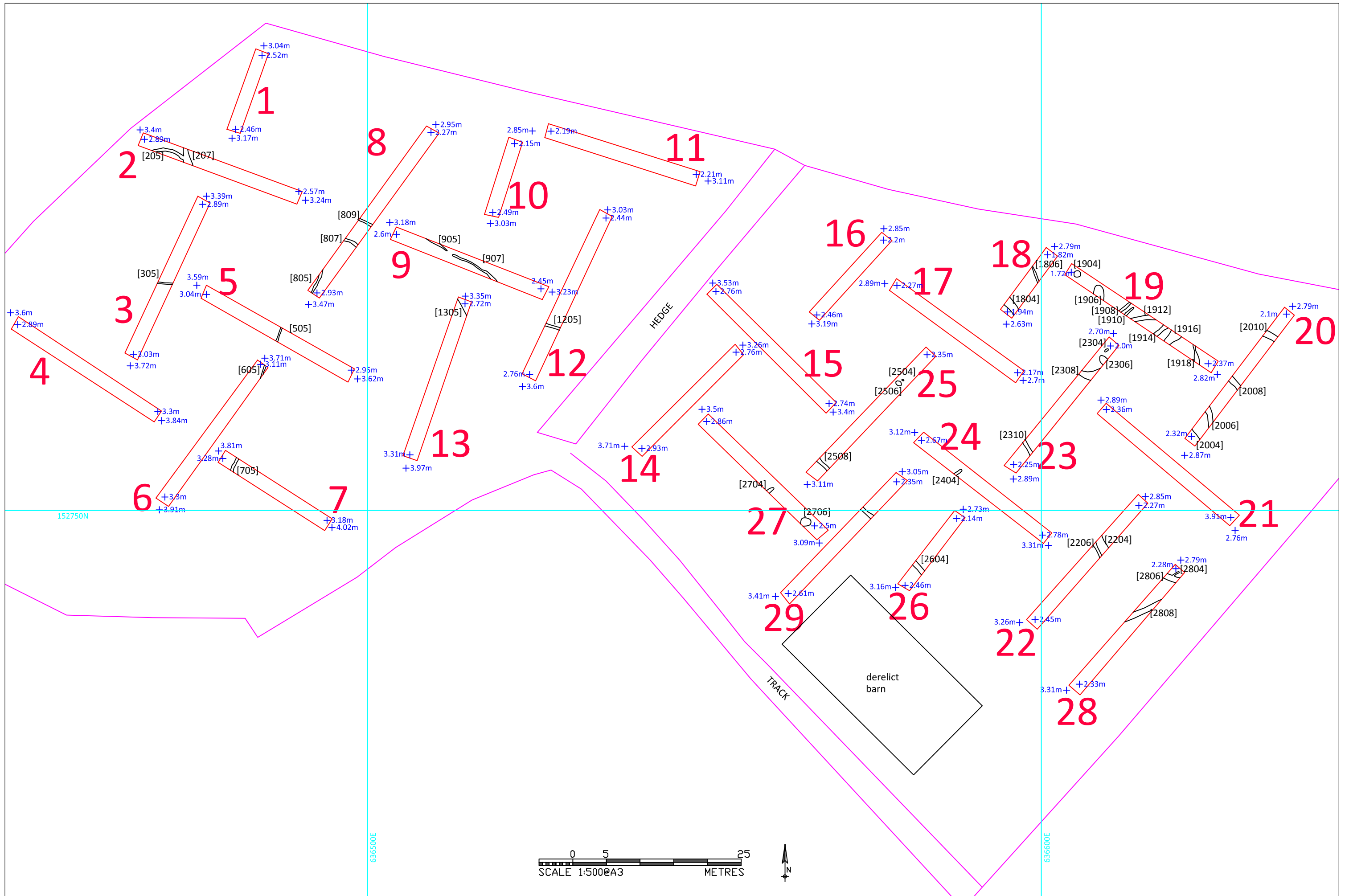

Figure 2A: Evaluation phase - Trench location, scale 1:500

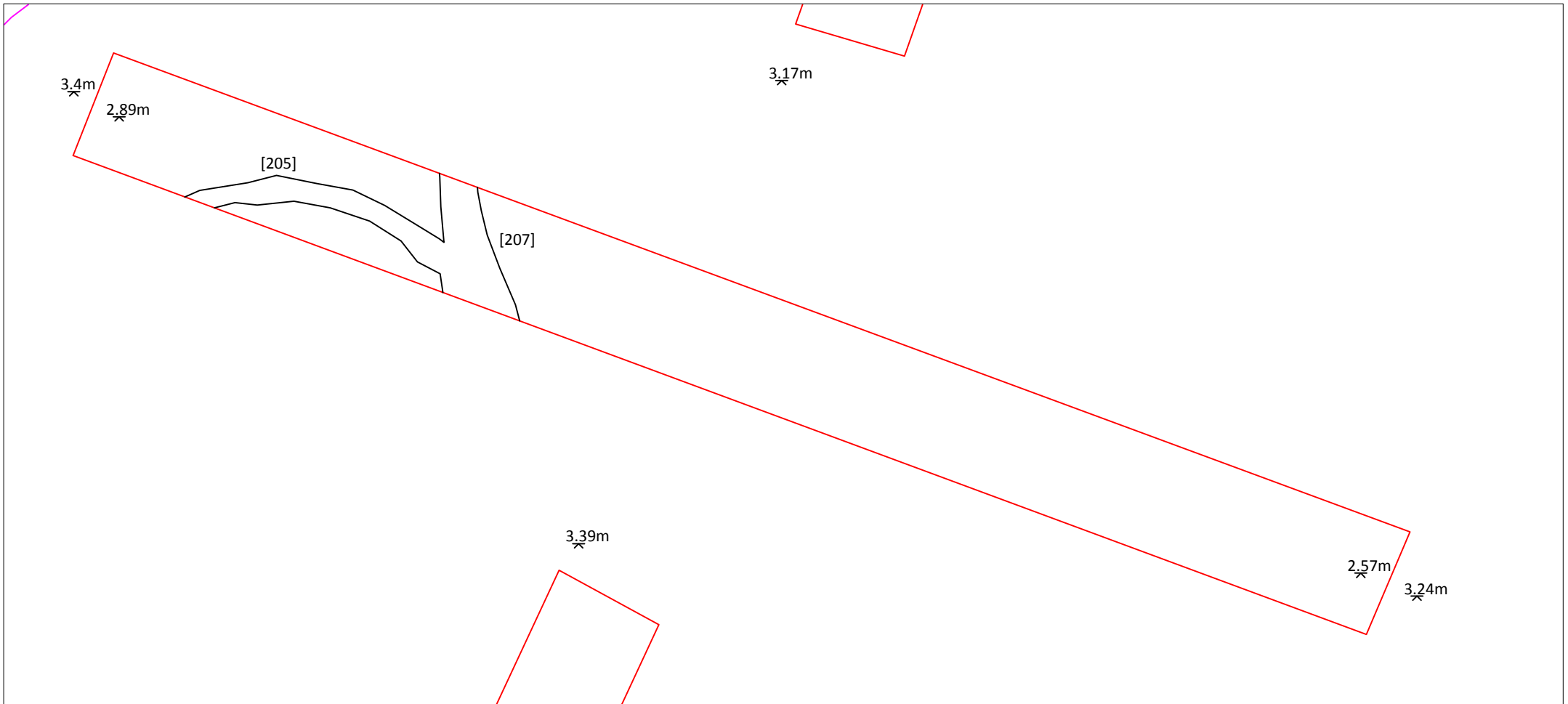

Figure 3 : Evaluation Trench 2, scale 1:100

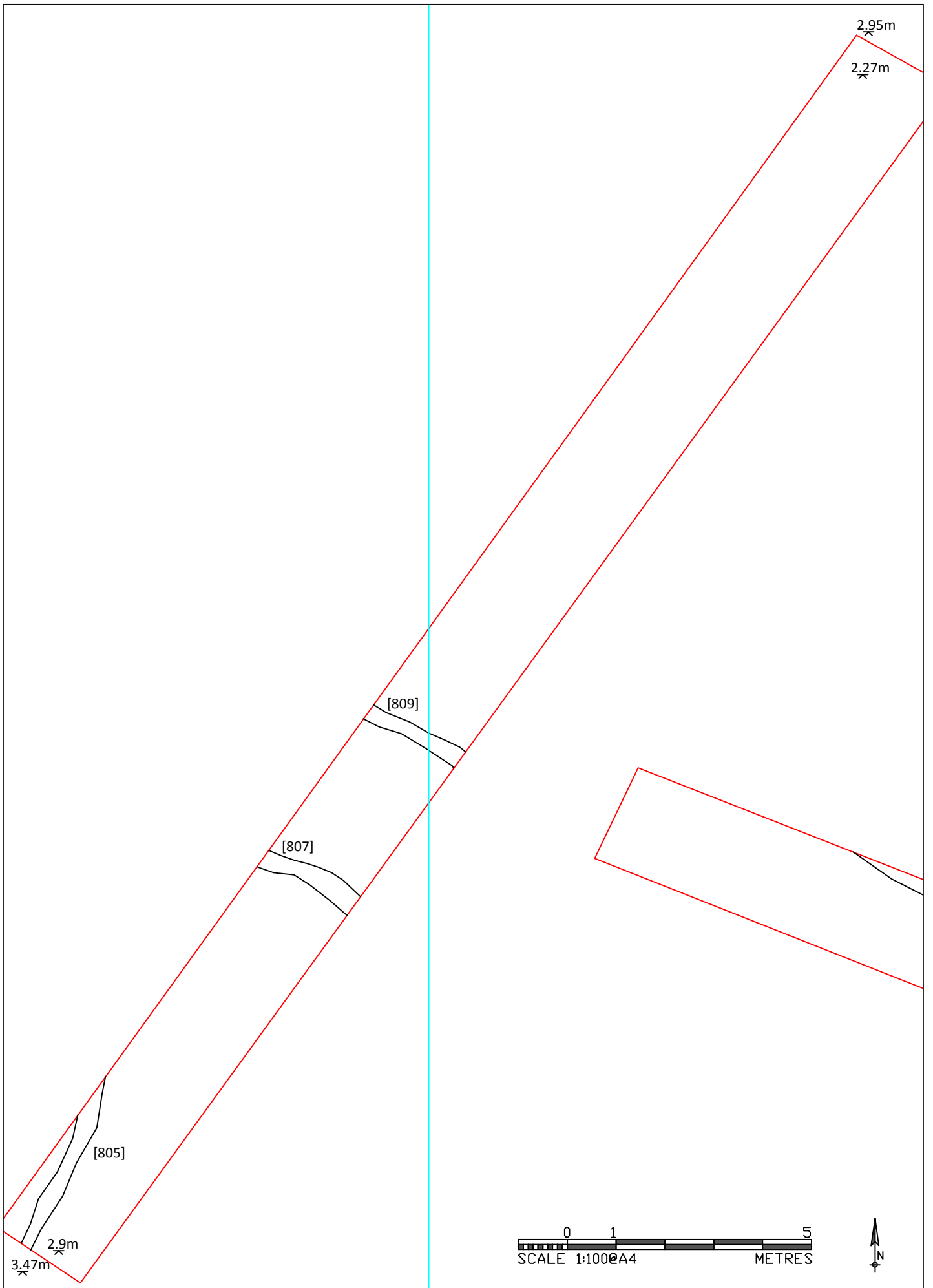

Figure 4 : Evaluation Trench 8, scale 1:100

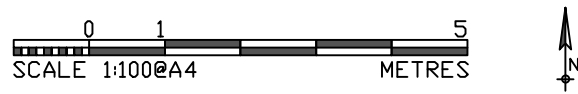
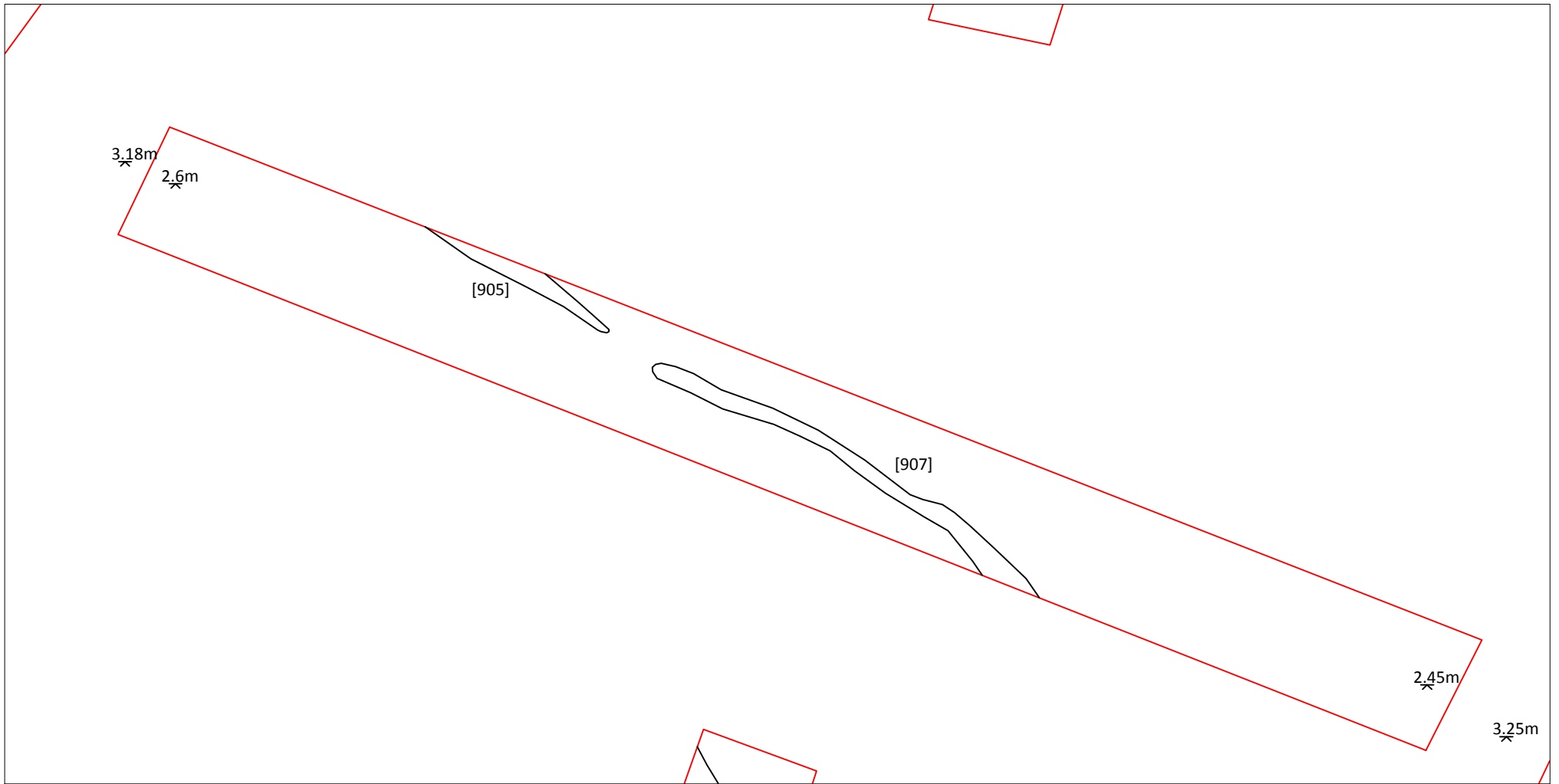

Figure 5: Evaluation Trench 9, scale 1:100

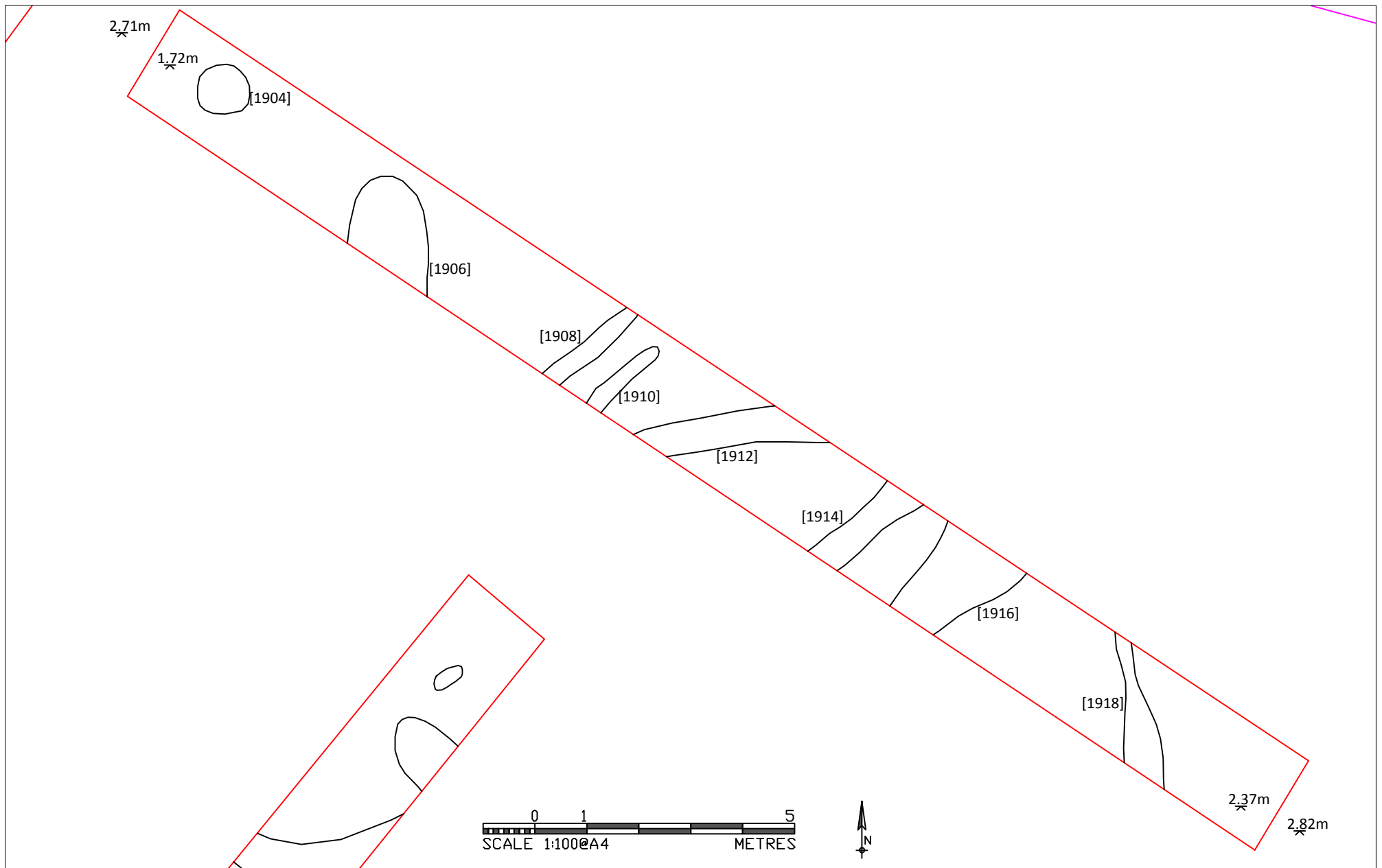

Figure 6: Evaluation Trench 19, scale 1:100

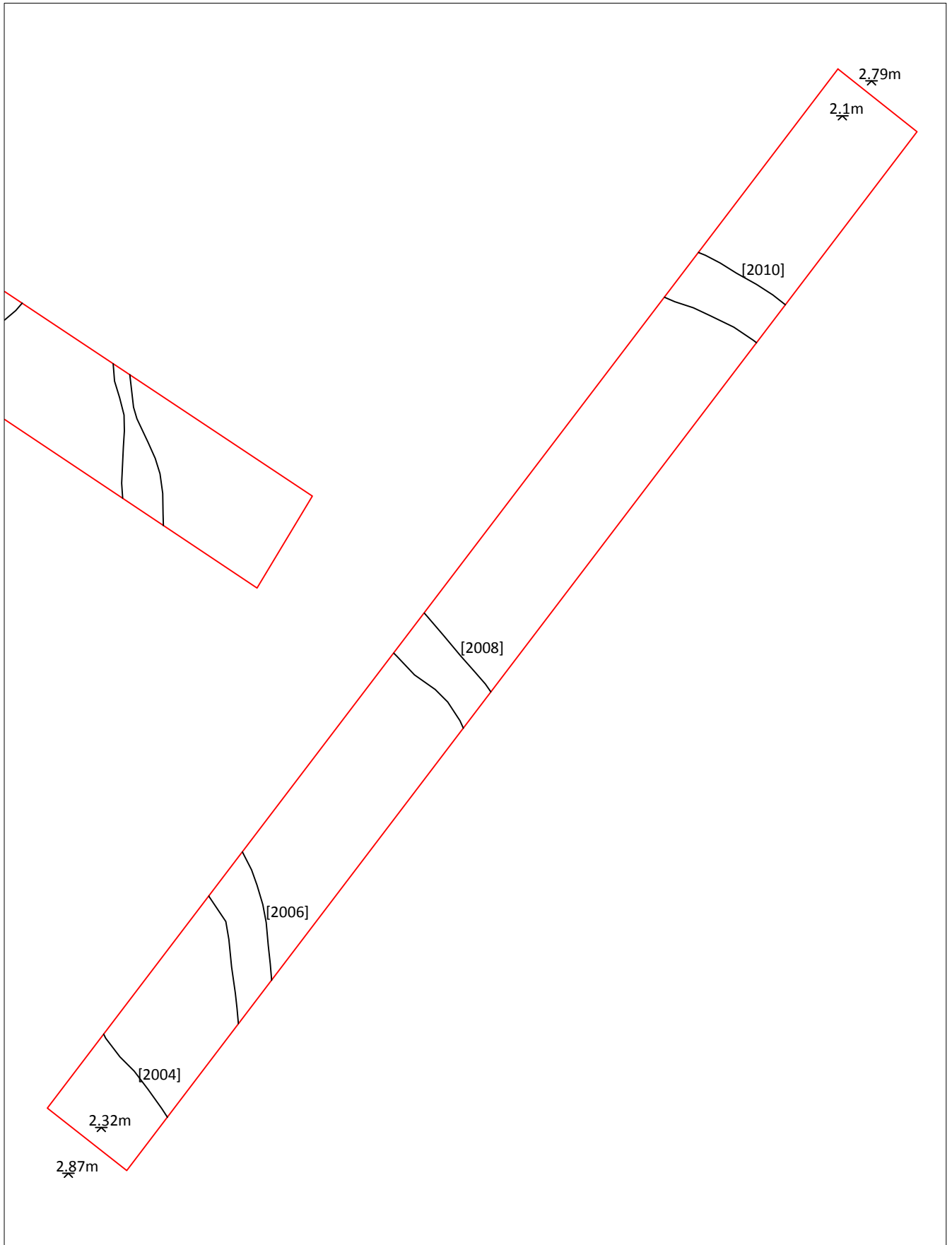

Figure 7: Evaluation Trench 20, scale 1:100

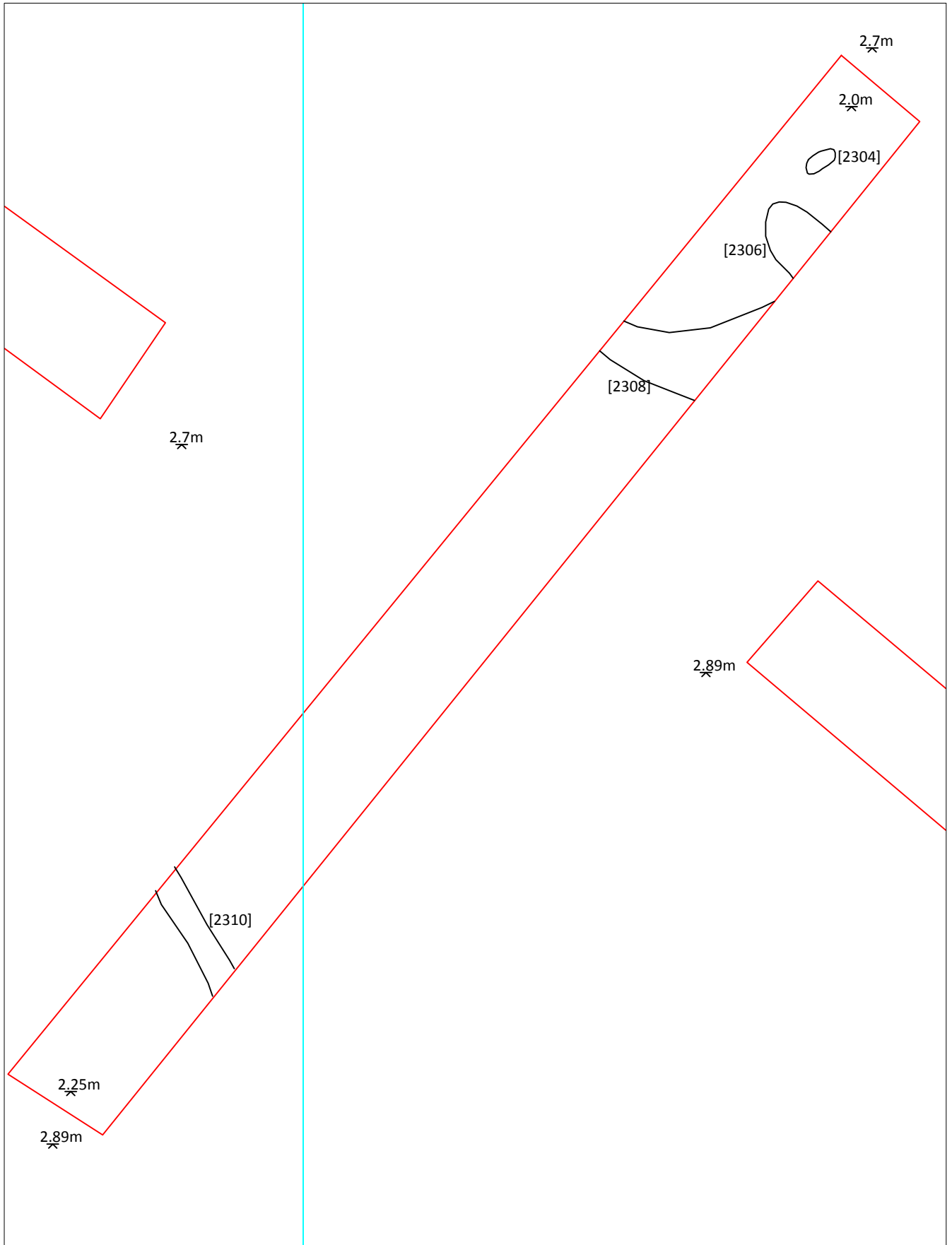

Figure 8: Evaluation Trench 23, scale 1:100

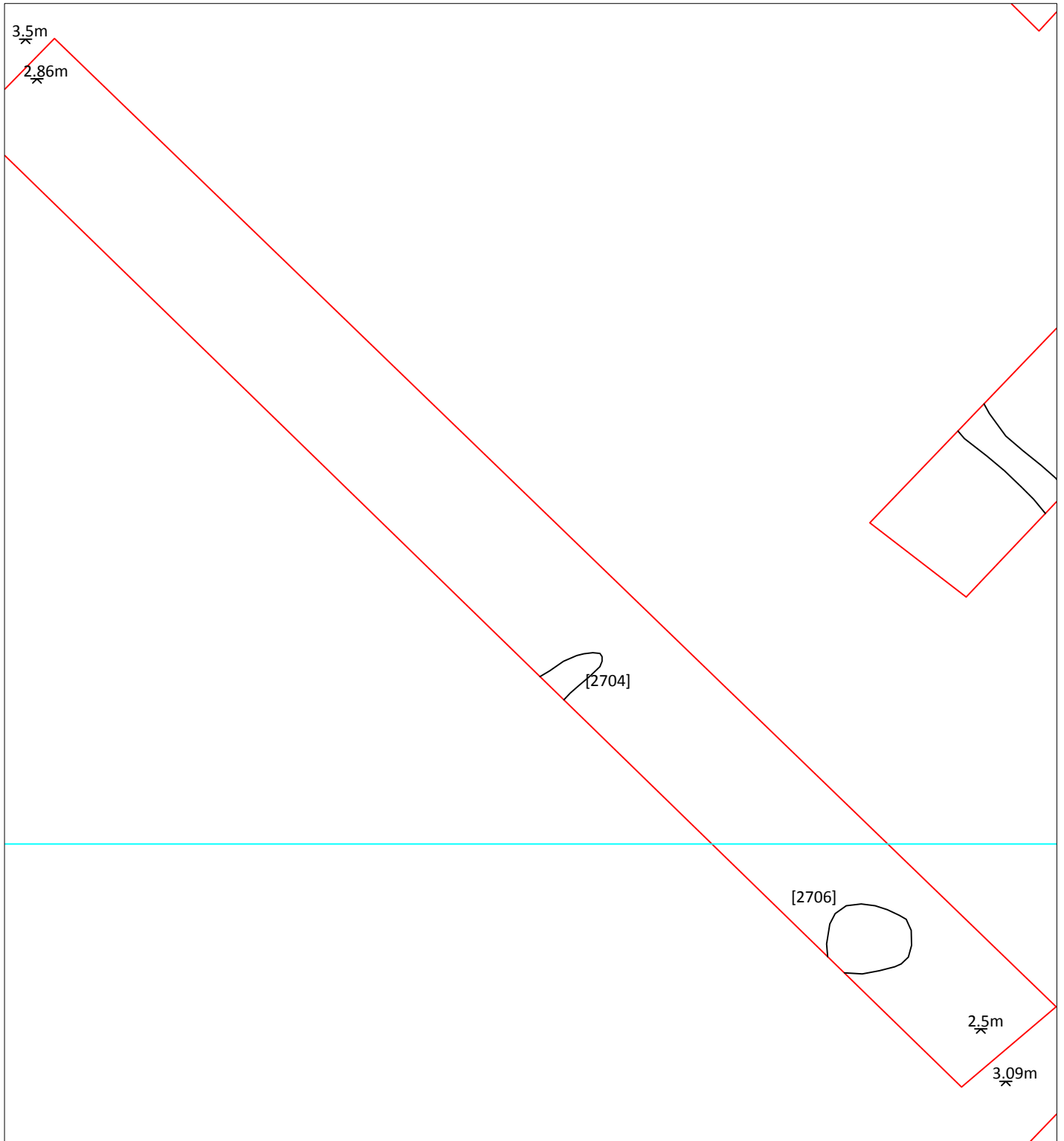

Figure 9: Evaluation Trench 27, scale 1:100

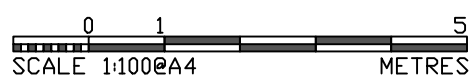
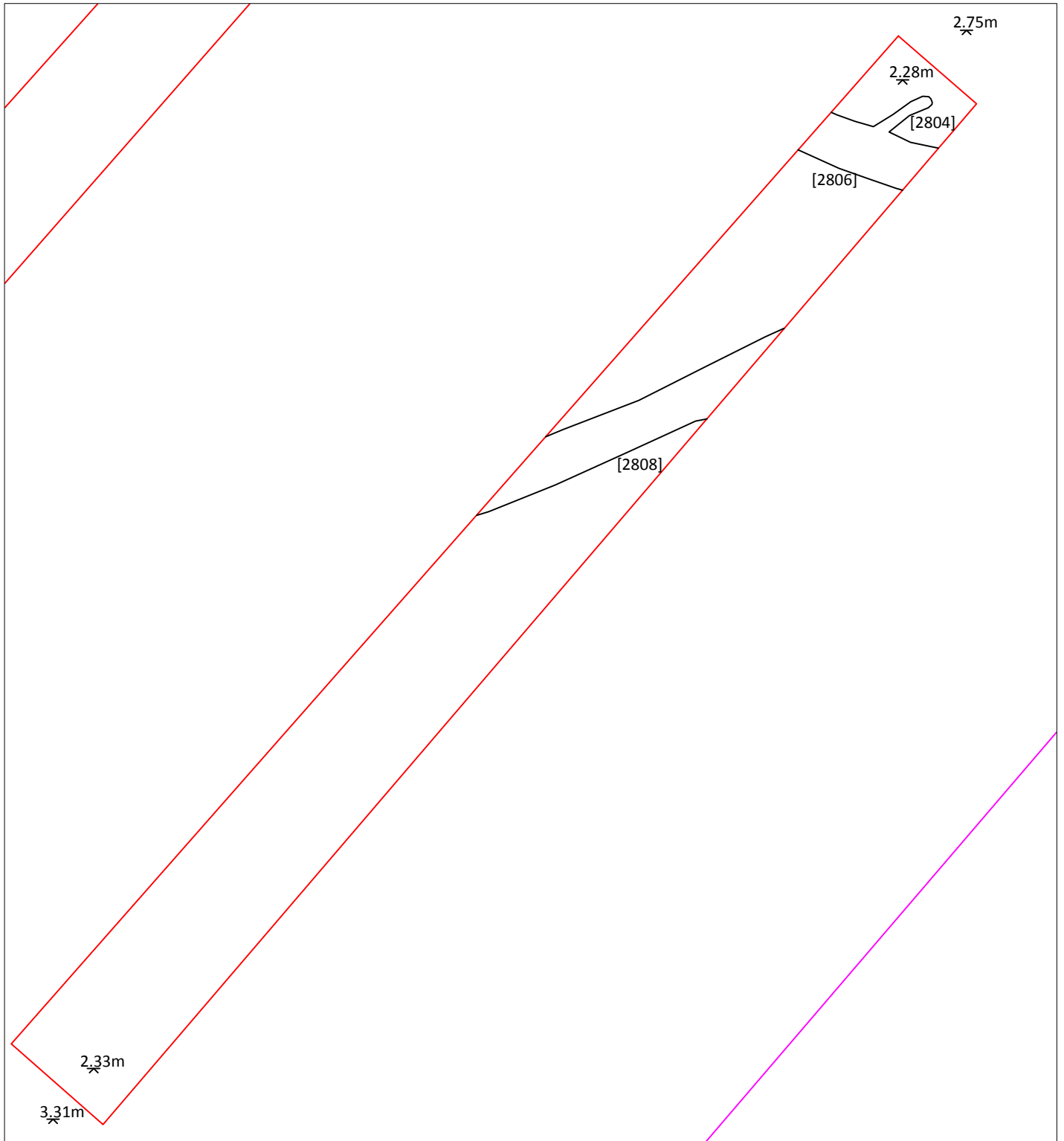

Figure 10: Evaluation Trench 28, scale 1:100



Plate 1, Trench 3 (looking NE)



Plate 2. Trench 12 (looking NE)



Plate 3. Unfinished Meso-Neolithic mace (Trench 18)



Plate 4. Trench 19 (looking NW)



Plate 5. Trench 20 (looking SW)



Plate 6. Trench 23 (looking NE)



Plate 7. Trench 25 (looking NE)



Plate 8. Trench 26 (looking NE)



Plate 9. Trench 27 (looking NE)